

**Menutree Website:**

- + Products / docu / downloads
- + Accessories
- + Connection cable / adapter
- + RS232
- + OP-programming cable

**QR-Code Website:**



Please make sure to update your drivers before using our products.

**Sensor-networking 4.0**

**Siemens S5**  
Read / Write  
PC-Schnittstelle



**Siemens S7**  
Read / Write  
PPS / MPI / DP





**Energieanalyse**  
(EN 60755, EN 60470-3)  
Echtzeit-Messung  
L1, L2, L3, N-Echtzeitanalyse  
bis 800 Messungen/Sek  
Spannungen bis 500 VAC  
Strome über 1000 A  
Hz / cos phi / Leistungsfaktor  
Wh / kWh / Schmelzleistung kW  
Energieverbrauch kWh

**Alle Messgrößen**  
U I f / °C / O2 / H2O, mg, kg, mN ...  
übertragbar, analysieren, überwachen, alarmieren  
zentral protokollieren = beobachten

Vorhandene Sensoren direkt einbinden  
analoge und digitale Ein- Ausgänge  
elektrisch und Messuren frei konfigurieren  
Messgrößen einfach über WEB eingeben

Klick-Montage auf Standard-Hutschiene  
Stromversorgung 230VAC / 24VDC

integrierte Webserver  
Zugriff auf alle Sensoren im Netz

Protokoll auf SD-Karte = FTP-Server  
in verschiedenen Datenformaten  
bei Grenzen E-Mail = Ausgänge über Netz

## Log messages via e-mail

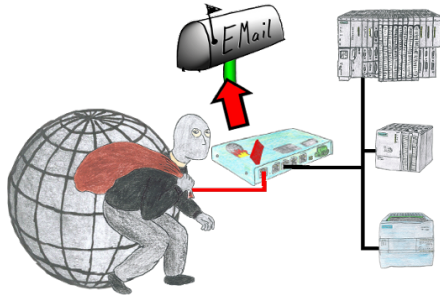

You want to be informed of access violations and range errors in the communication with your controls? No problem, with the S7-firewall you can be informed about each of these attacks / injuries by email to determine each polluter.

## Communication with PLCs without knowledge of the specific protocol

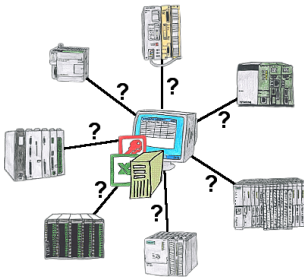

Who does not know the problem for a production-analysis still lack data that is stored in the controller. Without PLC-specific programming-packages you can not get the data and the software-technician has no time.

A one-time change to the evaluation-tool, the PLC-specific DLL-file integrated (also at Excel, Access, ...) and functions for reading and writing data of the controller are available.

## Data backup S5-PLC on FTP-server via dig. IO

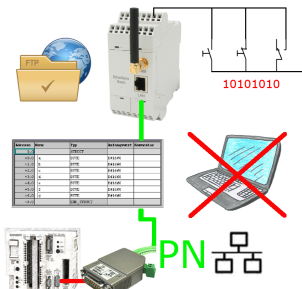

Via digital input triggered DB-backup/-restore without additional PC via PG-socket and Ethernet to FTP-server

## S7-CP-replacement (without LAN-CP to the PLC-device)

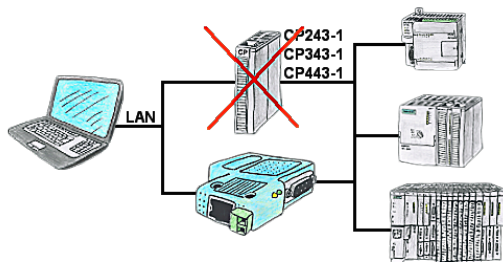

Do you have a S7-PLC-device without CP243-1, CP343-1 or CP443-1 and would like to connect via LAN? Then plug the S7-LAN on the PLC-device and your access via RFC1006 is ready for use.

## Energy-data acquisition

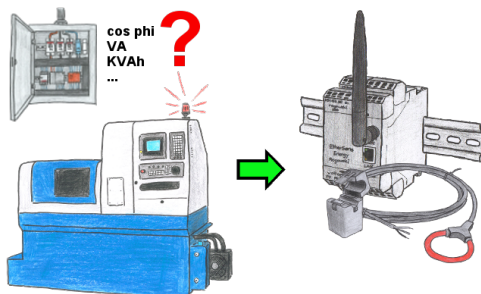

Do you also need the energy-consumption of your plant or need to determine the cos phi?  
With the EtherSens Energy you can capture and record by using a Rogowski-coil or folding-core the required values.

## Data backup S5-PLC on SD-card via dig. IO

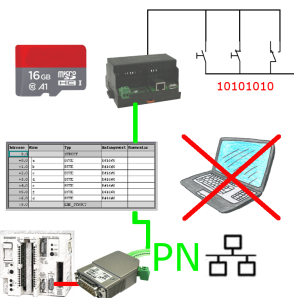

Via digital input triggered DB-backup/-restore without additional PC via PG-socket and Ethernet to SD-card