

**Menutree Website:**

- + Products / docu / downloads
- + Hardware
  - + PD-interface-multiplexer
  - + PG-MUX-II family
  - + PG-MUX-II for Siemens

**QR-Code Website:**



Please make sure to update your drivers before using our products.

Recognize missing Profinet participants

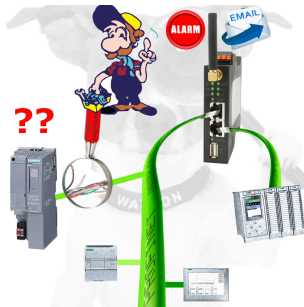

Recognize cable breakage, contact problems and line faults.  
Retransmissions and failures are logged and reported.  
Early acting before total failure of the participant.

## S5-PLC over RS232



Communication with S5-PLC via RS232, just how and with what?

Data-communication with S5-PLC from PC or other devices via RS232 (COM-port), which interface is required. Questions you don't have to worry about. With "S5 over RS232" you get the right interface-products for your interface of the PLC.

Which one you use then is up to you.

## Data backup S7-PLC over MPI/Profibus on USB-stick via dig. IO

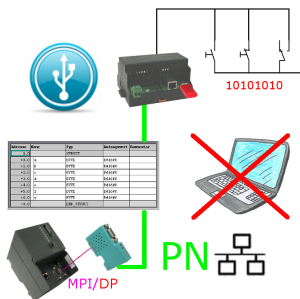

Device	Name	Type	Address	Start	End
1	1	1	1	1	1
2	2	2	2	2	2
3	3	3	3	3	3
4	4	4	4	4	4
5	5	5	5	5	5
6	6	6	6	6	6
7	7	7	7	7	7
8	8	8	8	8	8
9	9	9	9	9	9
10	10	10	10	10	10
11	11	11	11	11	11
12	12	12	12	12	12
13	13	13	13	13	13
14	14	14	14	14	14

Via digital input triggered DB-backup/-restore without additional PC via MPI/Profibus to USB-stick

## Data backup S5-PLC on FTP-Server

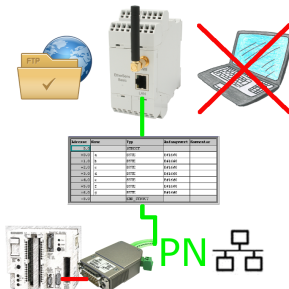

S5-PLC triggered DB-backup/-restore without additional PC via PG-socket and Ethernet on FTP-server

## Worldwide remote-access thanks to our own cloud

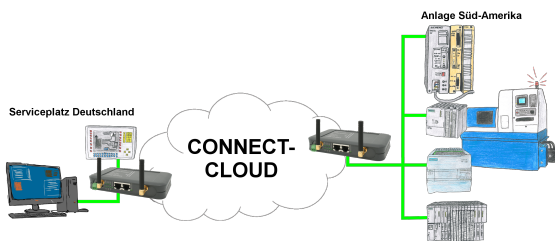

Worldwide remote-maintenance without additional costs thanks to our own cloud

Your devices connect to your own cloud, no matter where they are in the world. Only your devices are in your own private cloud, no one else has access to the cloud. In addition, you can provide each device with its own connection-password, so that the individual systems are protected despite the private cloud.

No registration on any portals, no hidden additional costs, your devices in your own cloud are always accessible.

This is how remote maintenance/remote access is fun.

## Integrated WebServer

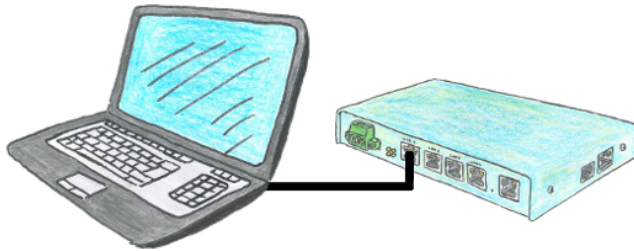

You would like to use a device that is small and handy and reasonably parameterizable yet? No problem, with the TELE-Router you fulfill all these requirements. The device is parameterizable via an integrated web server, connections self-explanatory.

## Universal coupling

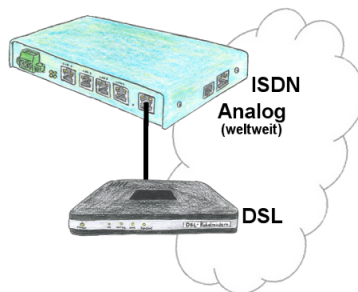

You need a family of devices with which you can solve all your requirements? No problem! With the TELE-router you are able to establish a connection via analog, ISDN or PPPoE (DSL cable modem). The devices are compatible with each other in each case, so that no further additional hardware is needed.