

Menutree Website:

- + Products / docu / downloads
- + Hardware
 - + Programming devices
 - + Programming adapter S7
 - + WLAN/WIFI
 - + WLAN/WIFI-SETs
 - + S5/S7-BRIDGE-WIFI-sets

QR-Code Website:



Please make sure to update your drivers before using our products.

Setting the PLC time

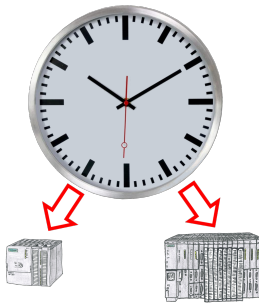

Summer-/winter-time switching, yet this buzzword is one term. Always in March and October the problem of time-change to the PLCs of their plant(s). Capture the controllers in the "S7-PLC exact time synchronization"-tool and automates setting the time in the controllers.

No change on the PLC-program necessary!
Whether MPI/Profibus via S7-LAN or Profinet!

Data backup S7-PLC PN-port on SD-card via dig. IO

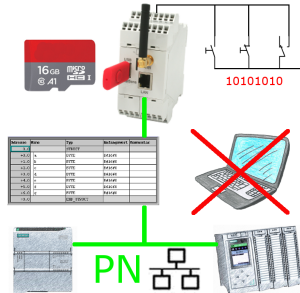

Via digital input triggered DB-backup/-restore without additional PC via PN-port to SD-card

S7-300/400 (MPI/DP) to S7-300/400 (MPI/DP)

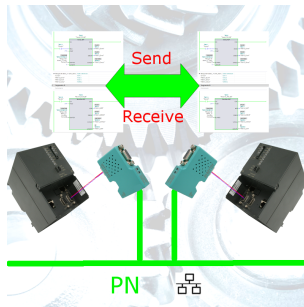

Coupling S7-controller with MPI/Profibus at S7-controller with MPI/Profibus via network

S7-1200/1500 to S5

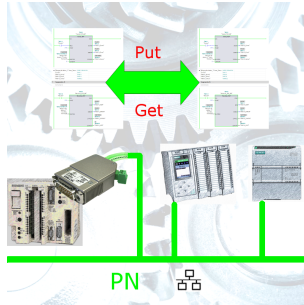

Coupling S7-controller with PN-port at S5-controller with PD-port via network

Protection of data areas in the PLC

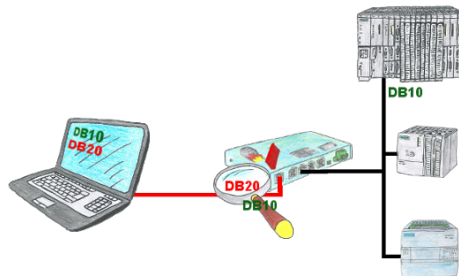

You have in your facility machinery with complex program structures and want to prevent that the users do not change comprehensible content? No problem, with the S7-firewall you can assign specific data fields to each user or even generally protect certain data areas in the PLC.

S7-300/400 (MPI/DP) to S5

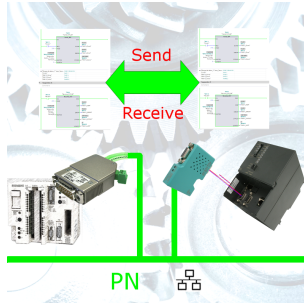

Coupling S7-controller with MPI/Profibus at S5-control with PD-port via network

Data backup S7-PLC PN-port on USB-stick

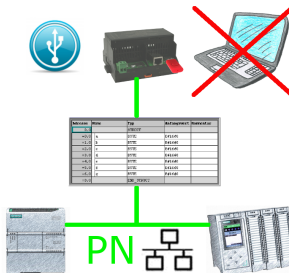

S7-PLC triggered DB-backup/-restore without additional PC via PN-port to USB-stick